

Agri-Urban Spectrum

Permacultural Concepts and the Urban-Rural Transect

- | | | | | |
|--------------------------|--------------------------|----------------------------------|---------------------------|------------------------------------|
| 1 Silviculture/Forestry | 5 Organic Farm | 9 Backyard Animals | 13 Farmers' Market | 17 Community Supported Agriculture |
| 2 Aquaculture/Fishery | 6 Agri-Tourism/Farm Stay | 10 Raised Garden Bed | 14 Community Garden* | 18 Rooftop Garden |
| 3 Agriculture/Farm/Ranch | 7 Farmstand | 11 Edible Landscape/ Streetscape | 15 Civic/Park Garden* | 19 Living Building |
| 4 Viticulture/Vineyard | 8 Boutique Farm | 12 Greenhouse | 16 Market/Festival Street | 20 Vertical Farm |

RURAL URBAN

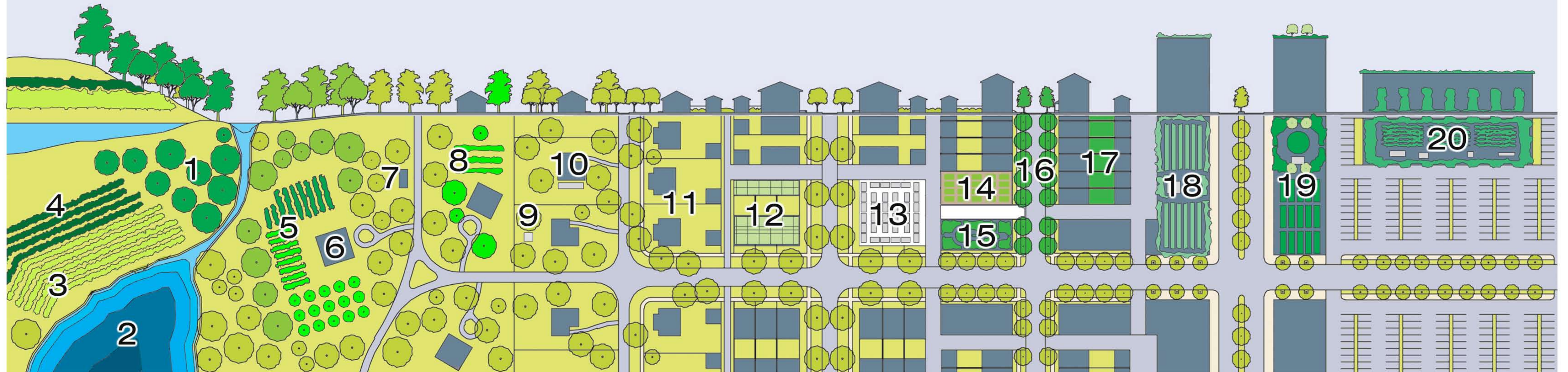

25 February 2011



Stephens
Planning & Design

www.stephensplanning.com
ric@stephensplanning.com

Permaculture is an ecological design system for sustainability in all aspects of human endeavor. It teaches us how to build natural homes, grow our own food, restore diminished landscapes and ecosystems, catch rainwater, build communities and much more. Permaculture.org
 * Community, Civic and Park Gardens are ideal sites for Community Emergency Centers which could include emergency equipment, supplies, portable toilets and manual water pumps.

Urban agriculture is the growing of plants and raising of animals within and around cities. The most striking feature of urban agriculture, which distinguishes it from rural agriculture, is that it is integrated into the urban economic and ecological system: urban agriculture is embedded in--and interacting with--the urban ecosystem. RUAf.org

Urban-to-Rural Transect courtesy of NewUrbanism.org